

Systemic innovations for
transformative solutions to
flooding in Bangladesh

The story of Rahela

Women living at the floodplain of the Teesta river in the Northwest region of Bangladesh (Gangachara Upazilla, Rangpur district)

- Interview excerpts (15 November 2016)

-*We were living on a macha (raised platform) for several days when my house went under water during 2014 flood*
-*I was cooking for my family. my only child (5 months old) was sleeping in a hand distance from me on a toshok (mattress) in the macha*
-*I searched for more than half and hours in the turbid, turbulent water*
-*I am a terrible mother*
-*My husband left me*
-*I don't want to be a mother again*

Who was responsible?

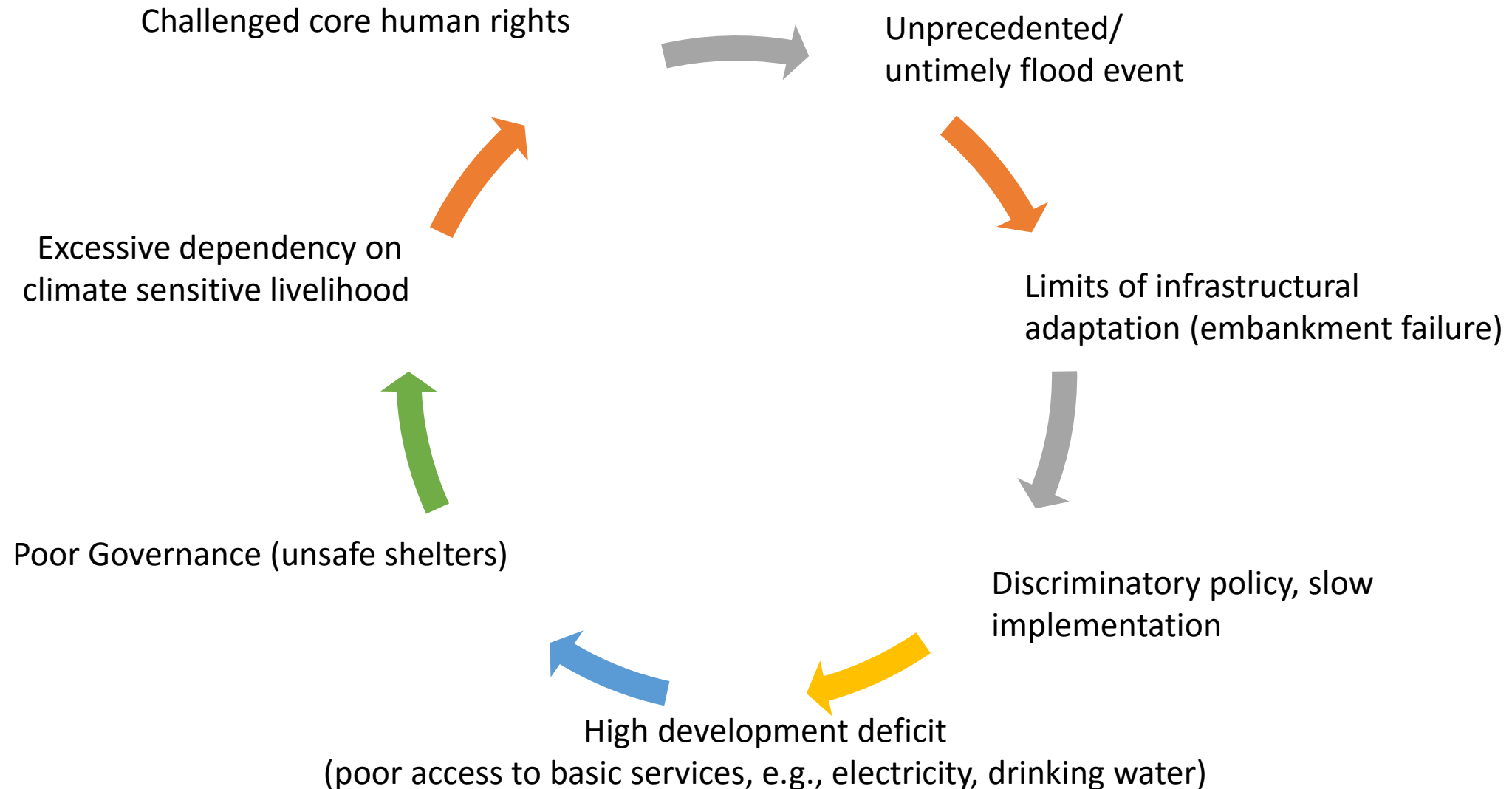

Cascading impacts-Loss and damage

Economic
loss and
damage

- Damage of house, embankment
- Loss of income, additional expenses

Non-
Economic
Loss

- Living in false sense of security
- Trauma from loss of family
- Loss of dignity, self-esteem, confidence
- Fear of displacement

Cause

Effect

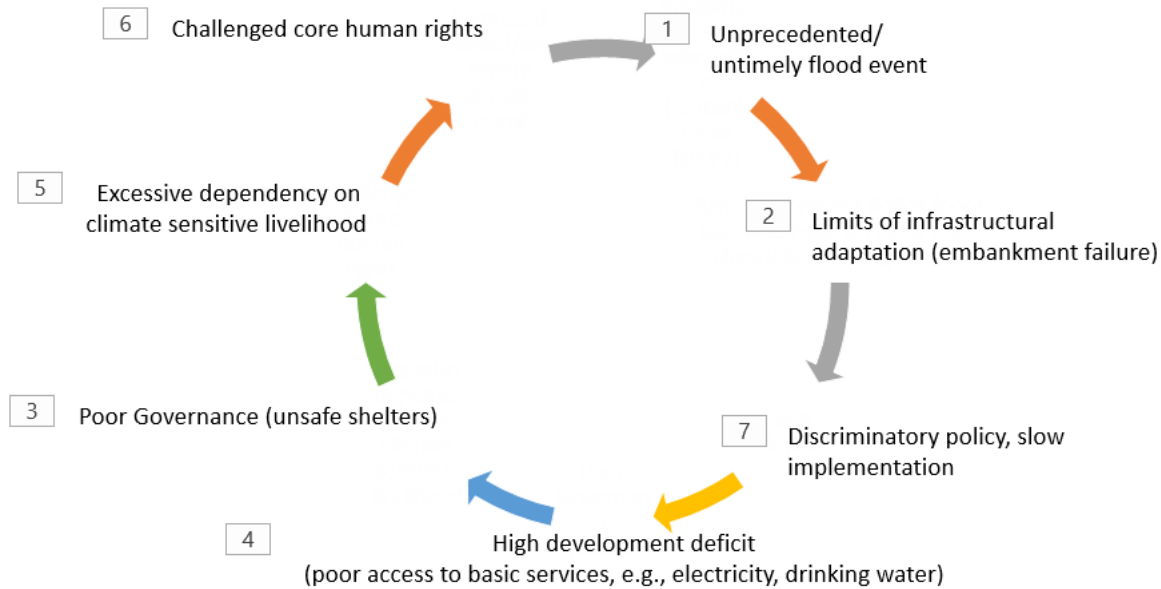

Economic
loss and
damage

- Damage of house, embankment
- Loss of income, additional expenses

Non-
Economic
Loss

- Living in false sense of security
- Trauma from loss of family
- Loss of dignity, self-esteem, confidence
- Fear of displacement

Vicious circle of loss and damage

In search of a platform to address loss and damage holistically

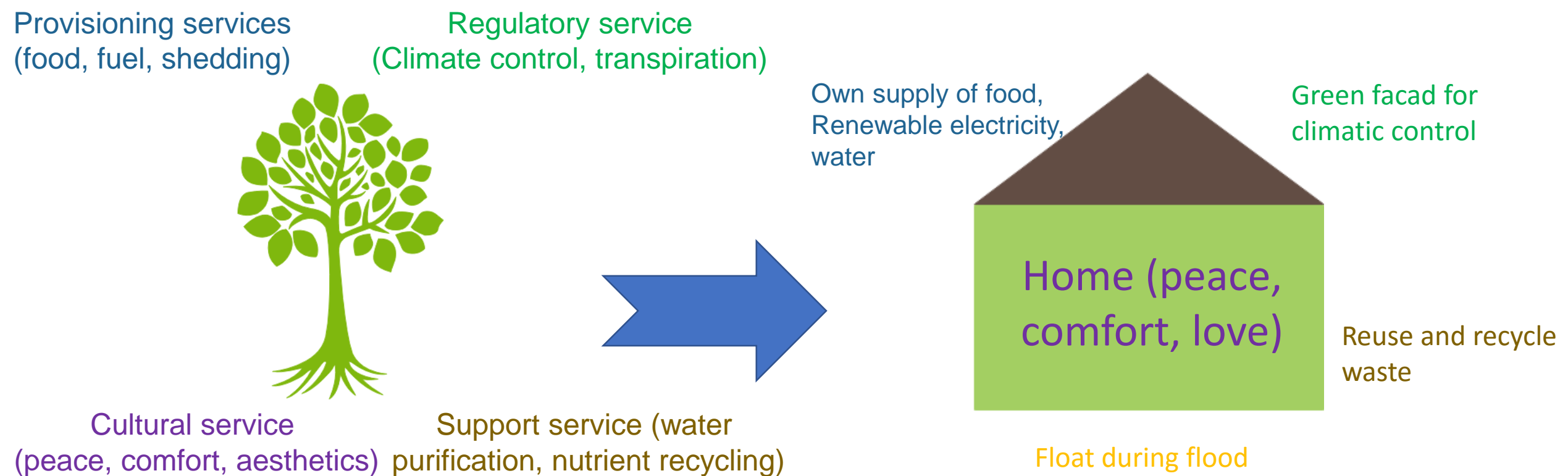

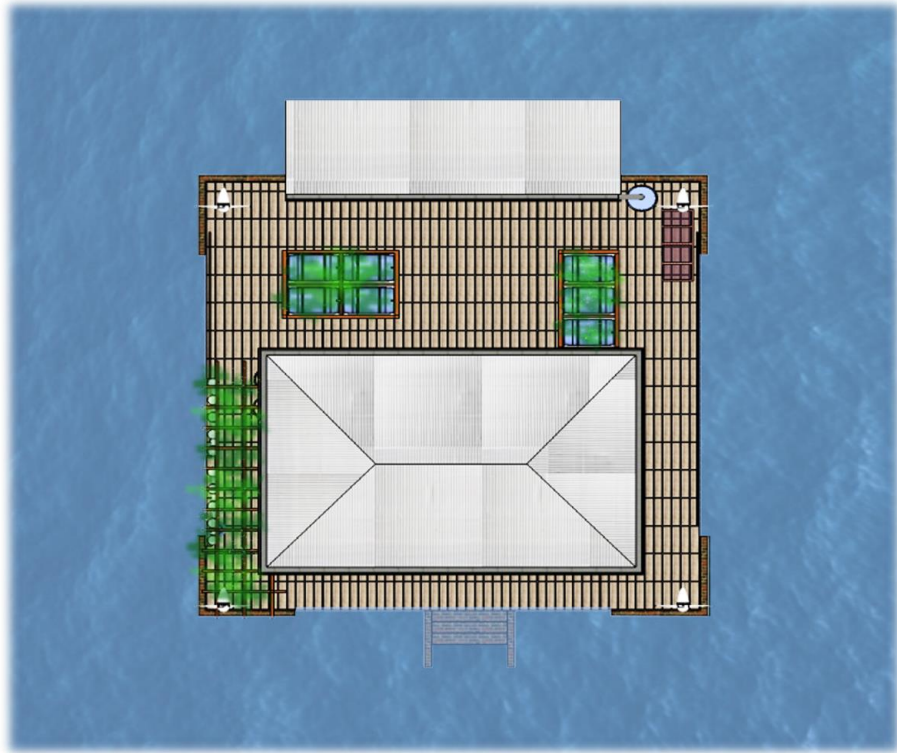

Architect A K M Sirajuddin and Team

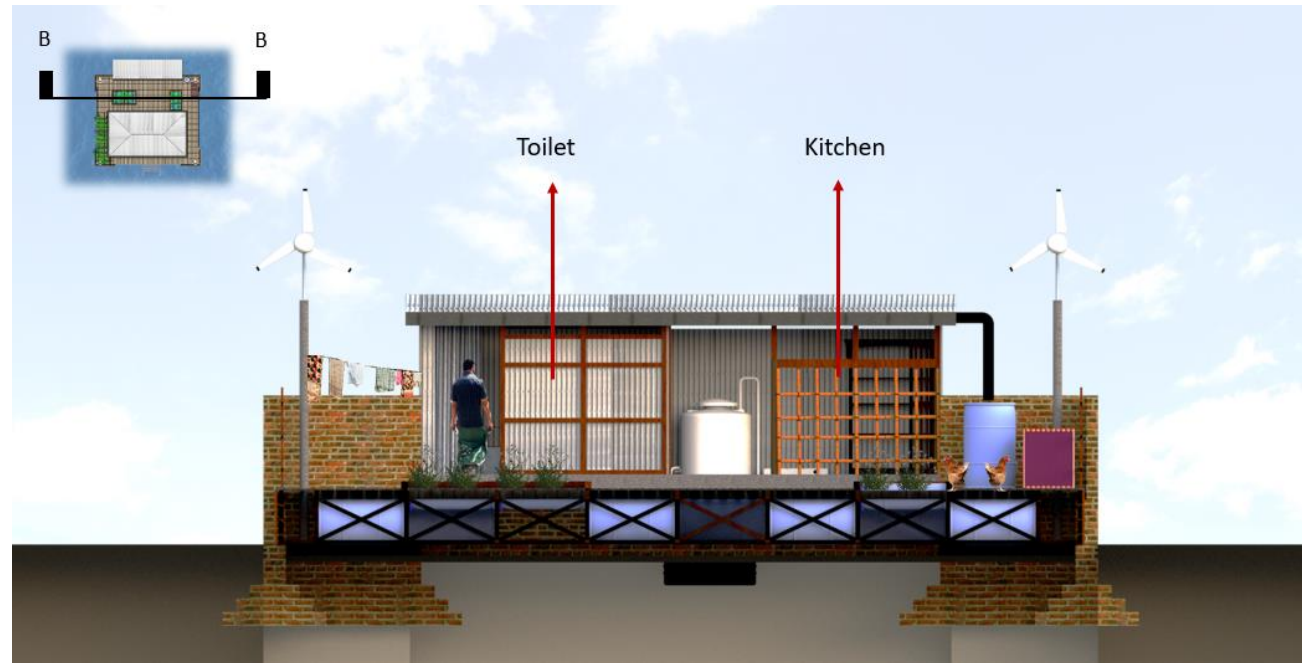

EXONOMETRIC VIEW

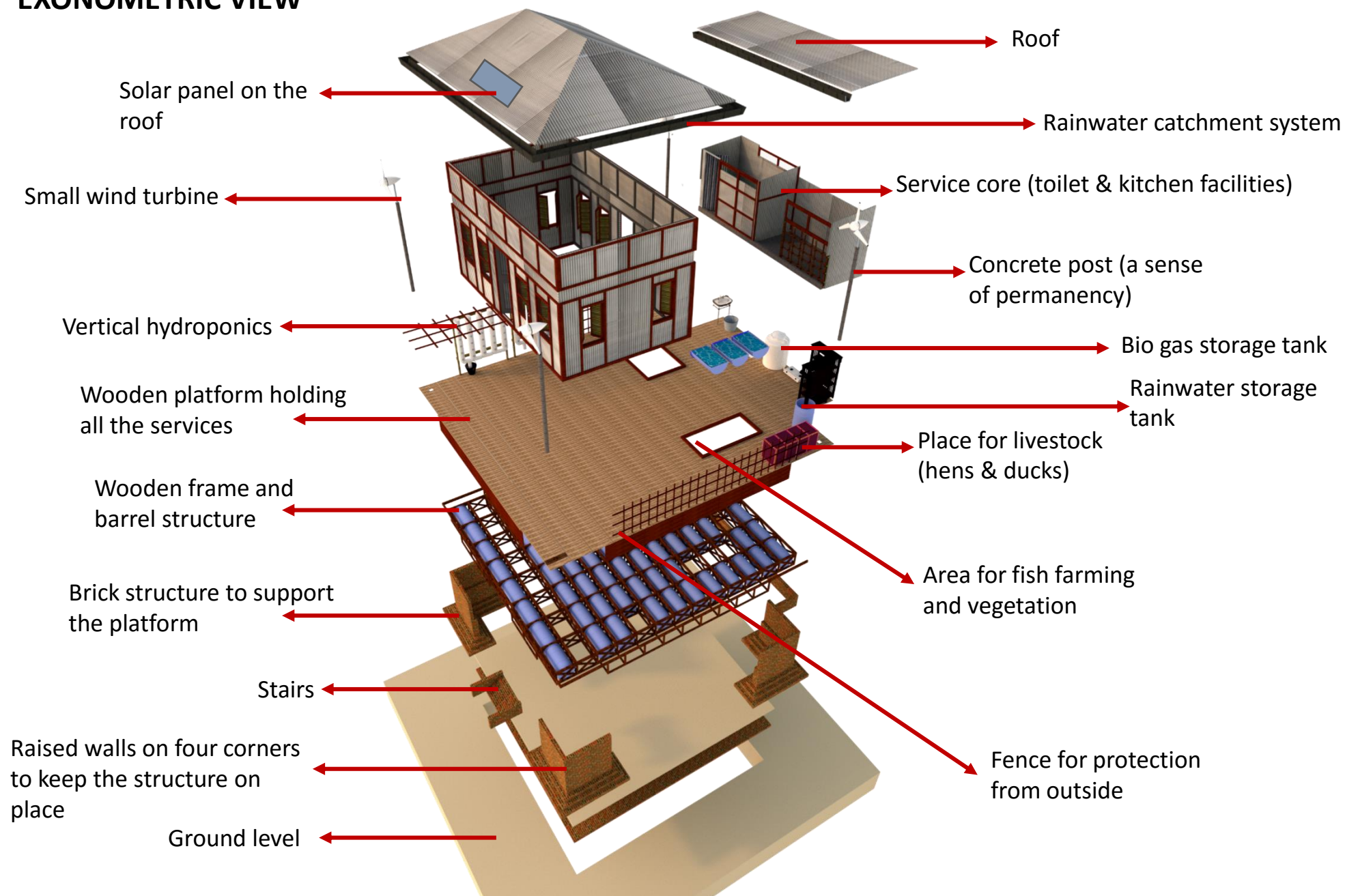



Team

Professor Ainun Nishat
Professor Ioan Fazey
Professor Mel Woods
Professor Andrew Allen
Roufa Khanum
A K M Sirajuddin
Sohel Awrangeb
Glenn Page
Daniel Jupp Kinna
Masum Ibrahim

Floating houses: Community-Based Flood Resilience Innovations in Bangladesh

Thank you

Nandan Mukherjee

Hydronation Scholar, University of Dundee and The Scottish Government

Director, Centre for Climate Change and Environmental Research (C3ER), BRAC University

nandan99@gmail.com